

# KOB21s Emergency Stop



- Integral shroud reduces risk of accidental push
  - Twist to reset
  - IP65 protective rating
  - Double insulated
  - Preformed 20mm knockouts
  - 600V 10A normally closed contact
- Breaks control circuits in emergencies  
Used in conjunction with Duomo gas detectors and electro-thermal fusible links

## Application

The KOB21s Emergency Stop push button is a high quality latching assembly suitable for ratings up to 600V at 10A. It is used to break control circuits in an emergency for applications such as gas supply isolation in laboratories, boiler houses and process burner plant. It is used in conjunction with Duomo gas detectors and thermal fusible links.

## Dimensions & Connections

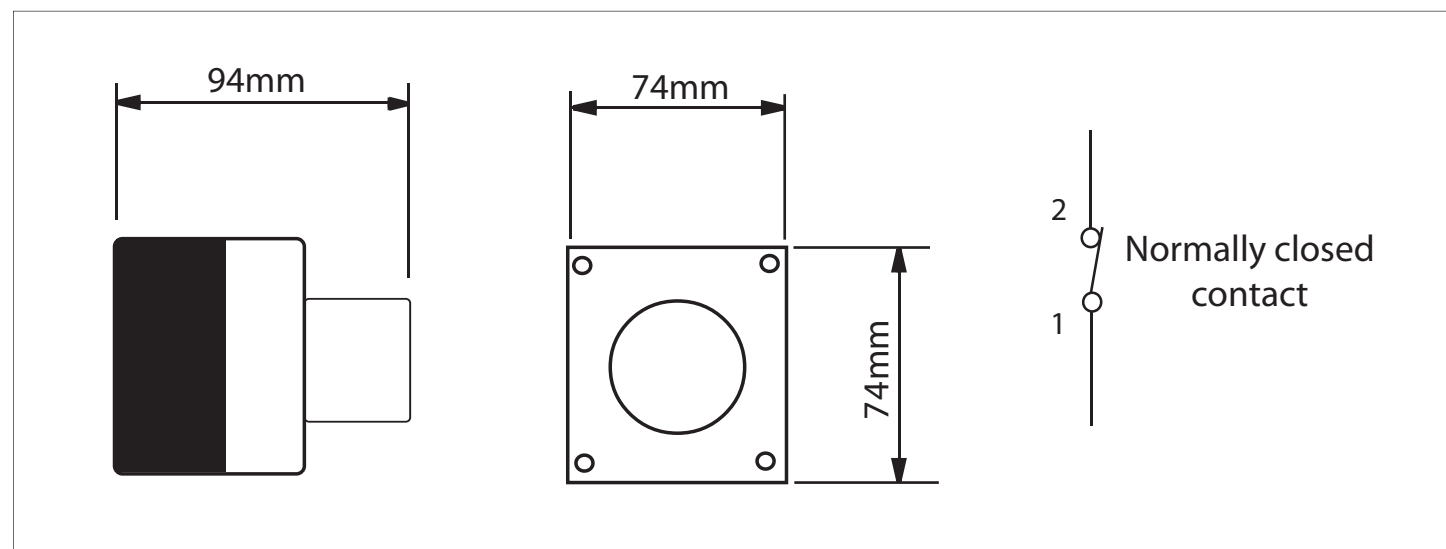

**WARNING!** Incorrect installation, adjustment, modification, operation or maintenance may cause injury or material damage. Read the instructions before use. This unit must be installed in accordance with the regulations in force.